

(Portage - Potter)

C-3-80

✓
8-180

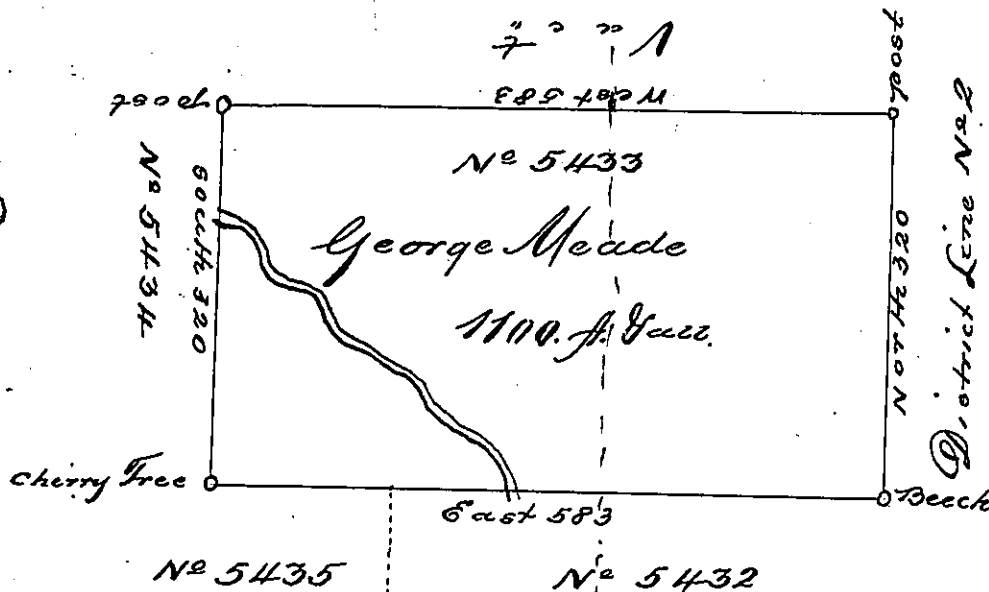

a 77 272

M-281

✓

✓

Situate on the Waters of Dinnemahoning Creek in the County of Northumberland. Containing 1100 acres and the usual allowance for Roads. Surveyed May 17th. 1794 to George Meade in pursuance of a Warrant No 5433. dated 3 March 1794.

Daniel Brodhead Esq^r

John Canan D. J.

IN TESTIMONY that the above is a copy of the original remaining on file in the Department of Internal Affairs of Pennsylvania, made conformably to an Act of Assembly approved the 16th day of February, 1833, I have hereunto set my Hand and caused the Seal of said Department to be affixed at Harrisburg, this third day of October 1899.

James W. Feltz
Secretary of Internal Affairs.